



# Passenger Facility Charge Application #8 – Public Notice

December 6, 2023

# Public Notice Requirements

- Pursuant to Section 158.24(b) of the Passenger Facility Charge (PFC) regulations, Norfolk Airport Authority (NAA) must provide notice of opportunity for public comment that includes the following information:
  - Project Descriptions
  - Project Justifications
  - PFC Level
  - PFC Revenue to be collected
  - Proposed effective and expiration dates
  - Contact information
  
- Any comments on this Public Notice should be sent by January 8, 2024 to:

Anthony Rondeau, P.E., C.M.  
Executive Vice President & Chief Development Officer  
Norfolk Airport Authority  
2200 Norview Avenue  
Norfolk, VA 23518-5807  
Email: [arondeau@norfolkairport.com](mailto:arondeau@norfolkairport.com)

# PFC Application Details

- New application for \$29,500,000 for 3 projects
  - 08-001 Long Term East Conversion to RON Parking
  - 08-002 Pedestrian Bridge People Movers
  - 08-003 Alpha Concourse Gate Addition
- All projects to be funded by PFCS on a pay-as-you-go basis

# 08-001 – Long Term East Conversion to RON Parking

## Description:

- Conversion of 35,000 square yards of existing long term vehicle parking into five remain over night aircraft parking (RON) positions
- RON positions are accessed from the south side of Concourse B via existing pavement

## Objective:

- This project enhances capacity at ORF by adding additional RON positions at ORF

## Justification:

- Due to enplaned passenger growth at ORF over the last few years, the Authority is experiencing aircraft parking capacity issues at its gates on a nightly basis
- Conversion of long term east vehicle parking to RON positions will help alleviate that issues

## Estimated Cost:

Total Project Cost:	\$12,000,000
PFC Share:	\$6,000,000

## Project Dates:

Implementation:	November 2021
Completion:	September 2023

# 08-001 – Long Term East Conversion to RON Parking



December 6, 2023

# 08-002 – Pedestrian Bridge People Movers

## Description:

- Pedestrian Bridge is an existing 354' long enclosed structure that serves as point-to-point access between the Arrivals and Departures Terminal Buildings at ORF
- Currently there is no moving walkway on the bridge to assist passengers with the walking distance
- Project will install 2 moving walkways in the Pedestrian Bridge

## Objective:

- Project will make it easier for passengers, including passengers requiring accommodations under the Americans with Disabilities Act, to transit between the Arrival and Departure Terminals

## Justification:

- Pedestrian Bridge is the primary circulation path between the long term parking garages and the departure gates and from the departure gates to baggage claim
- Walking distance between the furthest airline gate and bag claim is 2,200 feet or 0.41 miles
- Some passengers, including elderly and those with disabilities, have difficulty with the walking distance
- Moving walkways will provide these passengers with a chance to rest while still moving through the terminal complex

## Estimated Cost:

Total Project Cost:	\$3,300,000
PFC Share:	\$500,000

## Project Dates:

Implementation:	November 2022
Completion:	February 2025



# 08-002 – Pedestrian Bridge People Movers



# 08-003 – Alpha Concourse Gate Addition

## Description:

- Design and construction of additional holdroom space and restrooms at the end of the existing Alpha Concourse
- Total expansion will be approximately 13,000 square feet with three holdrooms at 2,500 square feet each
- Includes 4 new passenger loading bridges intended to mitigate the need for ground loading operations currently occurring at the end of the Alpha Concourse
- Expansion is 100% eligible for PFCs

## Objective:

- This project enhances the capacity of ORF by adding 3 gates and 4 loading bridges intended to accommodate current operational needs

## Justification:

- Due to explained passenger growth over the past few years at ORF, the Authority is experiencing aircraft parking capacity issues at the gates
- Project will convert an area used for ground loading aircraft to holdroom space for 3 gates

## Estimated Cost:

Total Project Cost:	\$33,000,000
PFC Share:	\$23,000,000

## Project Dates:

Implementation:	January 2023
Completion:	December 2025



# 08-003 – Alpha Concourse Gate Addition

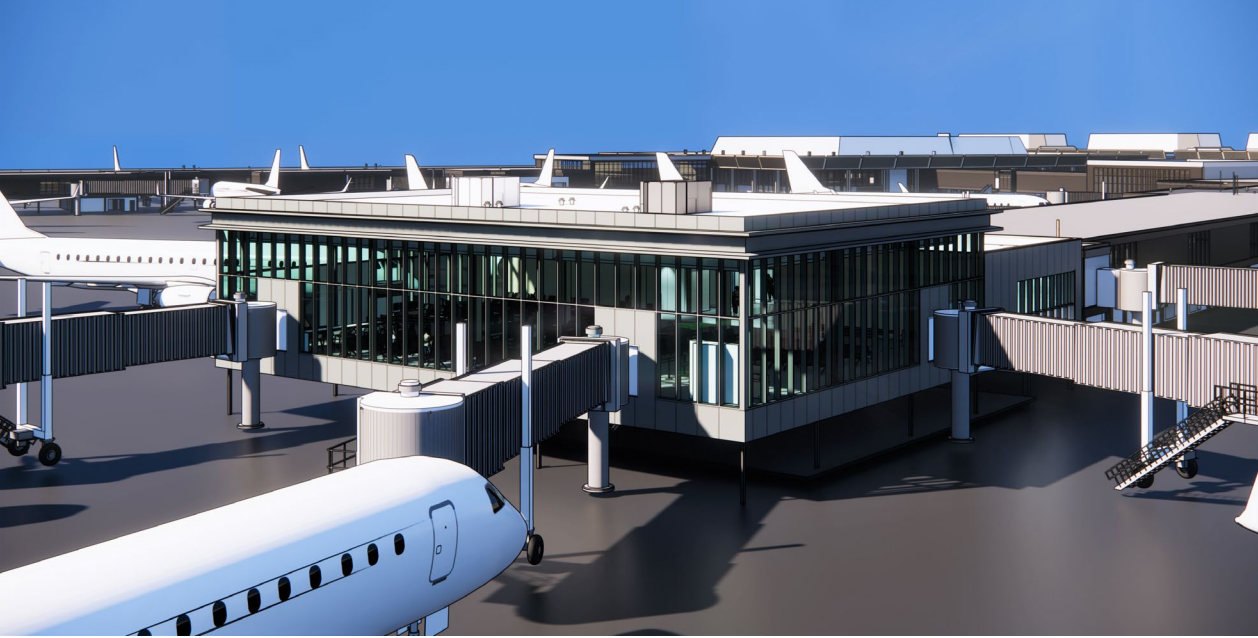

# Project Funding Sources

Project	Item #	Fiscal Year	Project Costs	Funding Sources							
				AIP Grants		BILs		State	PFC #8	Authority Funds	Total
				Entitle-ment	Discre-tionary	AIG	ATP				
Long Term East Conversion to RON Parking	08-001	2023	\$12,000	\$0	\$0	\$0	\$0	\$6,000	\$6,000	\$0	\$12,000
Pedestrian Bridge People Movers	08-002	2023	\$3,300	\$0	\$2,300	\$0	\$0	\$0	\$500	\$500	\$3,300
Alpha Concourse Gate Addition	08-003	2024	\$33,000	\$0	\$0	\$10,000	\$0	\$0	\$23,000	\$0	\$33,000
<b>Total</b>			<b>\$48,300</b>	<b>\$0</b>	<b>\$2,300</b>	<b>\$10,000</b>	<b>\$0</b>	<b>\$6,000</b>	<b>\$29,500</b>	<b>\$500</b>	<b>\$48,300</b>

# Summary of PFC Application

- PFC Level: \$4.50 per eligible enplaned passenger
- PFC Revenue to be Collected: \$29,500,000
- Charge Effective Date: Proposed application will become effective upon the expiration of PFC # 22-07-C-00 which is currently estimated to be fully collected by December 2025
- Charge Expiration Date: November 1, 2028